

Blackpool 1938 Levland Cub Council Committee Coach

This unique coach was introduced in 1938 and fitted out with a Burlingham body designed to Manager Walter Luff's specifications. It featured a carpeted floor, swivelling armchairs, six radiators, a clock and a wireless set. It had a telephone and microphone connecting the saloon to the driver's cab, and utensils were carried for making tea and coffee.

Its' finish was unusual, in that it was painted all over black with stainless steel trim, earning it the nickname "The Black Maria" among the staff. Internally it had alhambrinal decorative ceiling panels and French polished walnut woodwork.

Licensed not as a coach but as a private car, it remained in use until 1967 as a mobile committee room for members of the council. On withdrawal from service it had only covered approximately 18000 miles and the spare wheel had never been used!

INSTRUCTIONS

General

You will need a scissors, a craft knife or Stanley knife, a straight edge, contact adhesive and a round pencil to use as a former.

It will be seen that a red line has been drawn around some components. Cut out this area and glue to some stiff card (an old cereal box is ideal) and put aside to dry.

All fold lines should be scored before cutting out components.

Floor and body Formers

Cut out floor parts 1 and 2, and formers parts 3 to 6. Fold part 2 (printed side down) as shown in fig 1 and stick part 1 (printed side up) between tabs of floor. Stick parts 3 back to back with parts 4, and parts 5 back to back with 6. Stick the tabs on parts 4 to the floor, so that the black rectangles all face the front of the vehicle, then glue the longitudinal formers (5 & 6) between them where indicated on the floor, so that the two black rectangles on parts 5 face outwards at the rear wheel spaces. Cut out front section part 7, fold as in fig 2 and stick to the two white panels under the front end of the floor.

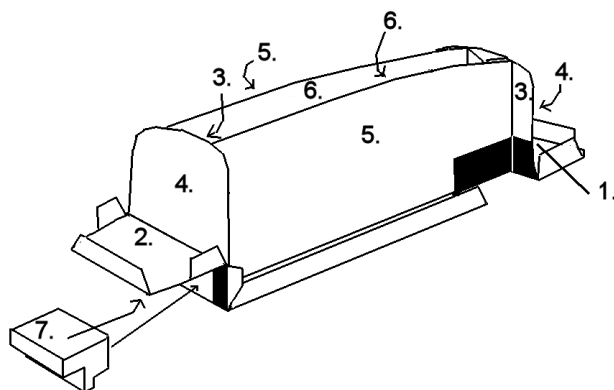

Body

Cut out main body, part 8, roof part 9 and rear joiners part 10. Carefully cut out the centre part of the main body where indicated and form the main body, carefully rolling the curved sections around a round pencil or similar. Curve the roof sides in the same way then stick into the centre section of the body. Note "Front" and "Back" are marked on the tabs on one side of the roof section. Cut out the small slots shown on parts 10 and curve them to follow the contours of the sides and back, then stick them behind the joins to form a curve at each corner of the rear of the body.

Stick body to chassis, so that floor is flush with bottom of body.

Wheels

Cut out wheel components 11 to 18 and make wheels as shown in fig 3. Stick wheels in place in wheel arches, noting that the shaded area on the front wheel hubs should be at the top of the wheel.

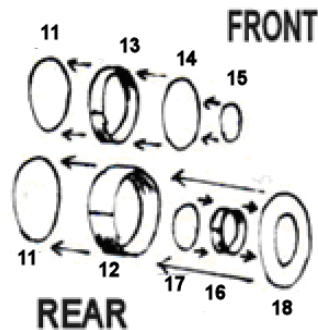

Wheel Arches and Mudguards

Cut out wheel arches 19 and 20 and mudguard tops 21. Stick wheel arches over panels on body sides (note front wheel arches are shorter at the front). Appearance can be improved by colouring edges with a black felt tipped pen before fixing in place.

Curve front mudguard tops 12 and stick over front edge of wheel arches in the slot you have cut. The outer edge should follow the line of the main body side. Using a felt tipped pen, colour underside black before sticking in place. See header sheet for positioning.

Details

Cut out headlights 22, colour outer edge black then stick in place over white circles on vehicle front. Cut out ventilators 23, again colour edges black and stick over the three small rectangles on the roof.

Your model is now complete! I hope you enjoyed making it – look out for others in the series.

